

VCEC WEST EXHIBITION LEVEL

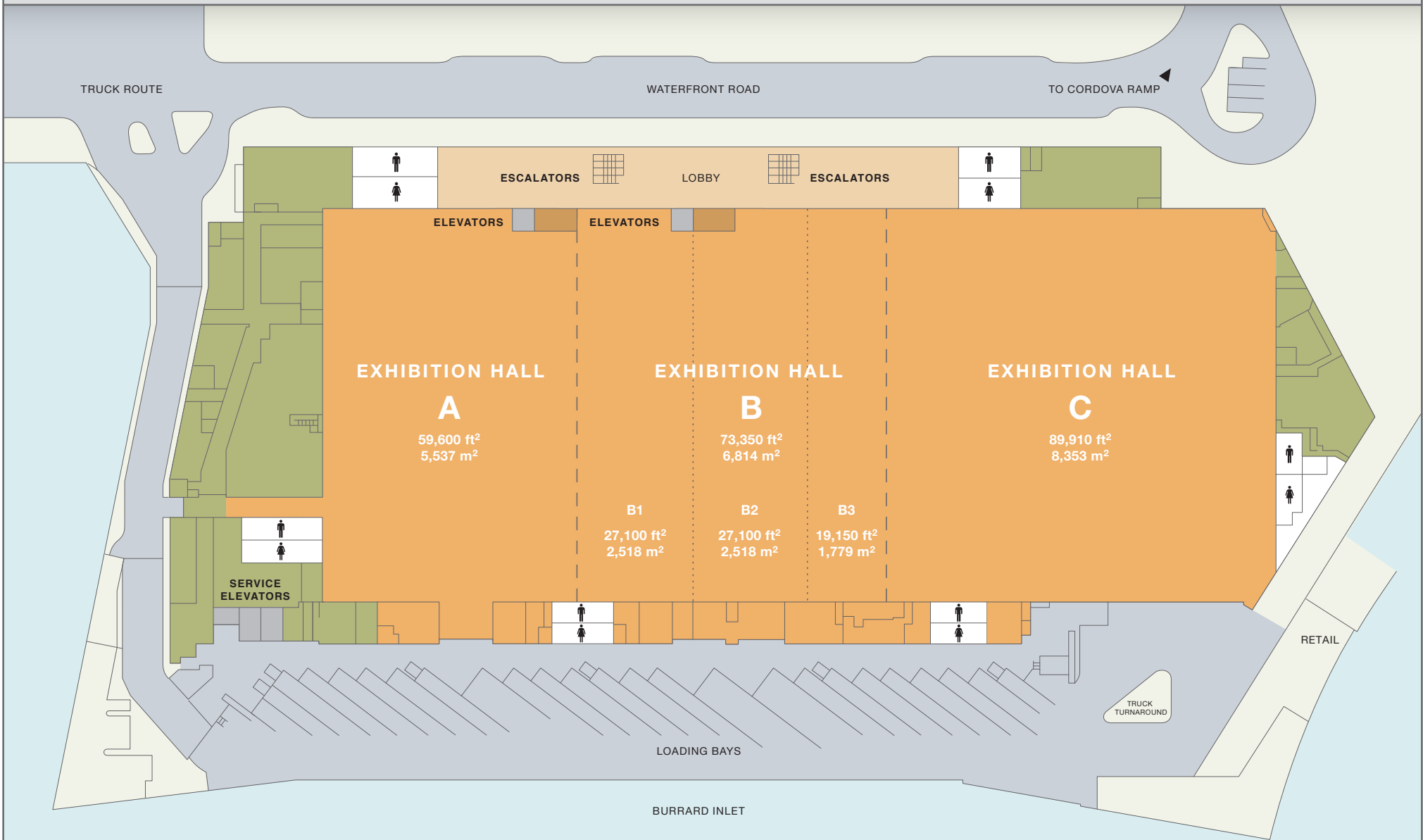

LOBBY / FOYER
 EXHIBITION
 BACK OF HOUSE

VCEC WEST EXHIBITION LEVEL

Exhibition Halls	Booth Capacities	Capacities (Maximum)				Useable Area		Dimensions		Ceiling Height	
		10' x 10' 3m x 3m	Theatre	Classroom	Dining	Reception	ft ²	m ²	Feet	Metres	Feet
A	327	4,500	3,060	3,400	4,547	59,600	5,537	300'3" x 196'5"	91.54 x 59.88	30'	9.144
B	387	3,600	3,678	4,080	3,676	73,350	6,814	300'3" x 239'6"	91.54 x 73.04	30'	9.144
C	482	6,750	4,512	5,000	7,163	89,910	8,353	300'3" x 300'6"	91.54 x 91.63	30'	9.144
AB	714	8,100	6,738	7,480	8,223	132,950	12,351	300'3" x 436"	91.54 x 132.88	30'	9.144
A & B1	474	5,850	4,260	4,850	5,947	86,700	8,055	300'3" x 286'7"	91.54 x 87.38	30'	9.144
A & B1 & B2	616	7,200	5,430	6,250	7,297	113,800	10,573	300'3" x 377'	91.54 x 114.88	30'	9.144
B1	147	1,350	1,200	1,450	1,400	27,100	2,518	300'3" x 90'2"	91.54 x 27.50	30'	9.144
B2	142	1,350	1,200	1,450	1,400	27,100	2,518	300'3" x 90'2"	91.54 x 27.50	30'	9.144
B3	98	900	800	1,230	926	19,150	1,779	300'3" x 59'	91.54 x 18.00	30'	9.144
B1 & B2	289	2,750	2,370	2,750	2,750	54,200	5,036	300'3" x 180'5"	91.54 x 55.00	30'	9.144
B2 & B3	240	2,275	1,950	2,270	2,275	46,250	4,297	300'3" x 149'3"	91.54 x 45.50	30'	9.144
B2 & B3 & C	722	9,000	6,882	7,850	9,438	136,160	12,650	300'3" x 450'	91.54 x 137.13	30'	9.144
B3 & C	580	8,550	5,682	6,400	8,088	109,060	10,132	300'3" x 359'7"	91.54 x 109.63	30'	9.144
BC	869	10,800	8,190	9,080	10,839	163,260	15,167	300'3" x 540'1"	91.54 x 164.63	30'	9.144
Combined ABC	1,196	14,850	11,250	12,480	15,386	222,860	20,704	300'3" x 736'7"	274.62 x 224.55	30'	9.144

Information subject to change.

FLOOR SUMMARY

Exhibition Halls

- 222,860 ft² (20,704 m²) of flexible exhibition space
- Divisible into three halls
- Convenient, adjacent loading bays
- 20,000 ft² (1,860 m²) pre-function space
- Disability access
- Harbour Lounge
- Access to retail

VCEC WEST LEVEL 1

◀ To VCEC East
To Burrard Street
To Thurlow Street

CANADA PLACE WAY



TERRACE

PLAZA

MEETING ROOMS
LOBBY / FOYER
BALLROOMS
TERRACE
BACK OF HOUSE

ESCALATORS

ESCALATORS

ELEVATORS

ELEVATORS

ELEVATORS

LOBBY

108 107 106 105 104 103 102 101

109

110

111 112 113

117 116 115 114

ELEVATORS

118

119 120

121 122

A 15,173 ft²
1,410 m²

B 15,186 ft²
1,411 m²

C 15,231 ft²
1,415 m²

D 9,192 ft²
854 m²

FOYER

BALLROOMS

TERRACE

VCEC WEST LEVEL 1

Ballrooms	Capacities (Maximum)						Useable Area		Dimensions		Ceiling Height	
	Theatre	Classroom	Dining	Reception	Boardroom	Hollow Square	ft ²	m ²	Feet	Metres	Feet	Metres
A	1,350	750	800	1,686	–	–	15,173	1,410	89'4" x 169'7"	27.25 x 51.73	55' ^(max)	16.75 ^(max)
B	1,350	750	800	1,687	–	–	15,186	1,411	89'5" x 169'7"	27.27 x 51.73	52'5" ^(max)	16.00 ^(max)
C	1,350	750	800	1,692	–	–	15,231	1,415	89'7" x 169'7"	27.35 x 51.73	43'6" ^(max)	13.30 ^(max)
D	675	450	500	1,021	–	–	9,192	854	61'7" x 169'7"	18.8 x 51.73	34'4" ^(max)	10.50 ^(max)
AB	2,700	1,500	1,600	3,761	–	–	30,359	2,821	178'9" x 169'7"	54.52 x 51.73	55' ^(max)	16.75 ^(max)
ABC	4,050	2,250	2,400	5,647	–	–	45,590	4,236	268'6" x 169'7"	81.87 x 51.73	55' ^(max)	16.75 ^(max)
BC	2,700	1,500	1,600	3,767	–	–	30,417	2,826	179'2" x 169'7"	54.62 x 51.73	52'5" ^(max)	16.00 ^(max)
BCD	3,375	1,950	2,100	4,906	–	–	39,609	3,680	268'6" x 169'7"	81.87 x 51.73	52'5" ^(max)	16.00 ^(max)
CD	2,025	1,149	1,300	3,025	–	–	24,423	2,269	–	–	43'6" ^(max)	13.30 ^(max)
Combined	4,725	2,700	2,900	6,087	–	–	54,782	5,090	–	–	61'7" ^(max)	18.80 ^(max)

Meeting Rooms	Capacities (Maximum)						Useable Area		Dimensions		Ceiling Height	
	Theatre	Classroom	Dining	Reception	Boardroom	Hollow Square	ft ²	m ²	Feet	Metres	Feet	Metres
101	42	24	30	56	18	14	498	46	23'4" x 21'4"	7.12 x 6.53	15'	4.57
102	42	24	30	56	18	14	498	46	23'4" x 21'4"	7.12 x 6.53	15'	4.57
101 & 102	84	48	60	112	28	24	996	92	23'4" x 42'5"	7.12 x 13.06	15'	4.57
103	42	24	30	56	18	14	498	46	23'4" x 21'4"	7.12 x 6.53	15'	4.57
104	42	24	30	56	18	14	498	46	23'4" x 21'4"	7.12 x 6.53	15'	4.57
103 & 104	84	48	60	112	28	24	996	92	23'4" x 42'8"	7.12 x 13.06	15'	4.57
105	42	24	30	54	16	12	484	45	23'4" x 20'9"	7.12 x 6.36	15'	4.57
106	42	24	30	54	16	12	484	45	23'4" x 20'9"	7.12 x 6.36	15'	4.57
105 & 106	84	48	60	108	24	20	968	90	23'4" x 41'7"	7.12 x 12.72	15'	4.57
107	42	24	30	54	16	12	486	45	23'5" x 20'9"	7.15 x 6.36	15'	4.57
108	42	24	30	54	16	12	486	45	23'5" x 20'9"	7.15 x 6.36	15'	4.57
107 & 108	84	48	60	108	24	20	972	90	23'4" x 41'7"	7.12 x 12.72	15'	4.57
109	190	117	130	260	38	50	2,340	217	60'8" x 38'4"	18.54 x 11.70	17'	5.18
110	190	117	130	260	38	50	2,340	217	60'8" x 38'4"	18.54 x 11.70	17'	5.18
109 & 110	380	234	260	520	60	70	4,680	434	60'8" x 76'8"	18.54 x 23.40	15'	4.57
111	50	33	40	78	18	16	685	65	33' x 20'9"	10.06 x 6.36	15'	4.57
112	50	33	40	78	18	16	685	64	33' x 20'9"	10.06 x 6.36	15'	4.57
111 & 112	100	66	80	156	30	34	1,370	129	33' x 41'7"	10.06 x 12.72	15'	4.57
113	60	33	40	81	18	16	729	68	27'4" x 26'6"	8.34 x 8.12	15'	4.57
114	60	36	40	90	20	16	852	79	34'8" x 24'5"	10.61 x 7.46	15'	4.57
115	60	36	40	90	20	16	852	79	34'8" x 24'5"	10.61 x 7.46	15'	4.57
114 & 115	120	72	80	180	30	32	1,704	158	34'8" x 49'	10.61 x 14.92	15'	4.57
116	60	36	40	90	20	16	852	79	34'8" x 24'5"	10.61 x 7.46	15'	4.57
117	60	36	40	90	20	16	852	79	34'8" x 24'5"	10.61 x 7.46	15'	4.57
116 & 117	120	72	80	180	30	32	1,704	158	34'8" x 49'	10.61 x 14.92	15'	4.57
118	150	99	120	227	50	44	2,044	190	54'7" x 37'4"	16.67 x 11.39	17'	5.18
119	72	48	50	103	26	22	930	86	37'4" x 24'9"	11.39 x 7.58	17'	5.18
120	90	54	60	123	26	24	1,106	103	37'4" x 29'6"	11.39 x 9.02	17'	5.18
119 & 120	162	102	110	226	52	46	2,036	189	37'4" x 54'5"	11.39 x 16.60	15'	4.57
118 to 120	312	201	230	453	50	80	4,080	379	74'7" x 54'7"	22.78 x 16.67	15'	4.57
121	105	66	70	145	30	34	1,308	122	42' x 31'2"	12.79 x 9.50	17'	5.18
122	105	66	70	142	30	34	1,281	119	42' x 30'5"	12.79 x 9.30	17'	5.18
121 & 122	210	132	140	287	40	54	2,589	241	42' x 61'7"	12.79 x 18.80	17'	5.18
Total							20,788	1,931				

FLOOR SUMMARY

Pre-function

- 82,000 ft² (7,600 m²) pre-function space
- Ocean views and outdoor terrace
- Fully staffed information booth
- Box office and coat check
- Disability access

Ballrooms

- 54,782 ft² (5,090 m²) of ballroom space
- Divisible into four ballrooms
- Ballroom D has three sides enclosed in glass, offering ocean and mountain views

Meeting Rooms

- 20,788 ft² (1,931 m²) of meeting space
- 22 fully serviced and configurable meeting rooms
- Sizes range from 500 to 5,000 ft² (46.5 to 464.5 m²)

Information subject to change.

VCEC WEST LEVEL 2



MEETING ROOMS LOBBY / FOYER TERRACE BACK OF HOUSE

VCEC WEST LEVEL 2

Meeting Rooms	Capacities (Maximum)						Useable Area		Dimensions		Ceiling Height	
	Theatre	Classroom	Dining	Reception	Boardroom	Hollow Square	ft²	m²	Feet	Metres	Feet	Metres
201	165	99	110	213	22	47	1,916	178	49'3" x 44'6"	15.03 x 13.58	17'	5.18
202	90	54	60	119	28	24	1,073	100	42'8" x 25'1"	13.04 x 7.64	15'	4.57
203	72	48	60	103	20	20	930	86	42'8" x 21'8"	13.04 x 6.63	15'	4.57
204	90	54	60	120	28	24	1,079	100	42'8" x 25'2"	13.04 x 7.69	15'	4.57
202 & 203	162	102	120	223	26	50	2,003	186	42'8" x 46'8"	13.04 x 14.27	15'	4.57
203 & 204	162	102	120	223	26	50	2,009	186	42'8" x 48'	13.04 x 14.32	15'	4.57
202 to 204	252	156	180	342	48	70	3,082	286	42'8" x 72'	13.04 x 21.96	15'	4.57
205	90	54	60	122	28	24	1,094	102	42'8" x 25'6"	13.04 x 7.79	15'	4.57
206	72	48	50	103	20	20	930	86	42'8" x 21'8"	13.04 x 6.63	15'	4.57
207	90	54	60	122	28	24	1,100	102	42'8" x 25'7"	13.04 x 7.84	15'	4.57
205 & 206	162	102	110	225	25	50	2,024	188	42'8" x 47'3"	13.04 x 14.42	15'	4.57
206 & 207	162	102	110	226	25	50	2,030	188	42'8" x 47'5"	13.04 x 14.47	15'	4.57
205 to 207	252	156	170	347	48	70	3,124	290	42'8" x 73'	13.04 x 22.26	15'	4.57
208	75	48	60	110	28	24	989	92	41'5" x 23'8"	12.66 x 7.26	15'	4.57
209	75	51	60	111	28	24	1,000	93	41'5" x 24'1"	12.66 x 7.34	15'	4.57
208 & 209	150	99	120	221	28	45	1,989	185	41'5" x 47'9"	12.66 x 14.60	15'	4.57
210	100	69	80	150	30	34	1,354	126	36'6" x 37'	11.16 x 11.27	15'	4.57
211	315	192	210	425	50	64	3,827	356	76'8" x 49'8"	23.40 x 15.19	17'	5.18
212	105	63	70	138	30	34	1,246	116	50' x 24'9"	15.27 x 7.58	17'	5.18
213	90	57	70	130	28	43	1,169	109	50' x 23'3"	15.27 x 7.11	17'	5.18
214	120	72	80	156	38	35	1,405	131	50' x 28'1"	15.27 x 8.55	17'	5.18
212 & 213	195	120	140	268	40	54	2,415	225	50' x 48'2"	15.27 x 14.69	15'	4.57
213 & 214	210	129	150	286	40	54	2,574	240	50' x 51'2"	15.27 x 15.60	15'	4.57
212 to 214	315	192	220	424	46	60	3,820	356	50' x 76'2"	15.27 x 23.24	15'	4.57
211 to 214	630	384	430	850	50	100	7,647	712	99'9" x 76'8"	30.46 x 23.40	15'	4.57
215	90	54	60	117	26	24	1,049	97	35'7" x 29'4"	10.89 x 8.95	15'	4.57
216	60	36	40	85	16	16	765	71	35'7" x 21'4"	10.89 x 6.53	15'	4.57
215 & 216	150	90	100	202	32	46	1,814	168	35'7" x 50'8"	10.89 x 15.48	15'	4.57
217	60	36	40	84	16	16	757	70	35'7" x 21'2"	10.89 x 6.46	15'	4.57
218	60	36	40	78	16	16	703	65	35'7" x 19'7"	10.89 x 6.00	15'	4.57
219	60	36	40	85	16	16	764	71	35'7" x 21'4"	10.89 x 6.52	15'	4.57
217 & 218	120	72	80	162	36	38	1,460	135	35'7" x 40'9"	10.89 x 12.46	15'	4.57
218 & 219	120	72	80	163	36	38	1,467	136	35'7" x 41'1"	10.89 x 12.52	15'	4.57
217 to 219	180	108	120	247	36	50	2,224	206	35'7" x 62'3"	10.89 x 18.98	15'	4.57
220	162	102	110	227	36	50	2,040	190	54'7" x 37'	16.67 x 11.37	17'	5.18
221	72	48	50	104	20	18	934	87	37'5" x 24'9"	11.42 x 7.60	17'	5.18
222	90	54	60	123	28	24	1,105	103	37'5" x 29'5"	11.42 x 8.99	17'	5.18
221 & 222	162	102	110	227	25	50	2,039	190	37'5" x 54'4"	11.42 x 16.59	17'	5.18
220 to 222	324	204	220	453	46	60	4,079	380	54'7" x 74'8"	16.67 x 22.79	17'	5.18
223	60	36	40	83	16	16	748	69	35'7" x 21'	10.87 x 6.39	15'	4.57
224	140	87	100	191	32	46	1,722	160	35'7" x 42'3"	10.87 x 14.72	15'	4.57
223 & 224	200	123	140	274	40	54	2,470	229	35'7" x 69'3"	10.87 x 21.11	15'	4.57
Total							29,699	2,760				

FLOOR SUMMARY

Meeting Rooms

- 29,699 ft² (2,760 m²) of meeting space
- 24 fully serviced and configurable meeting rooms
- Sizes range from 500 to 7,500 ft² (46.5 to 696.8 m²)
- 45,000 ft² (4,200 m²) pre-function space
- Outdoor terrace with ocean view

Information subject to change.

VCEC WEST LEVEL 3 (SUMMIT)

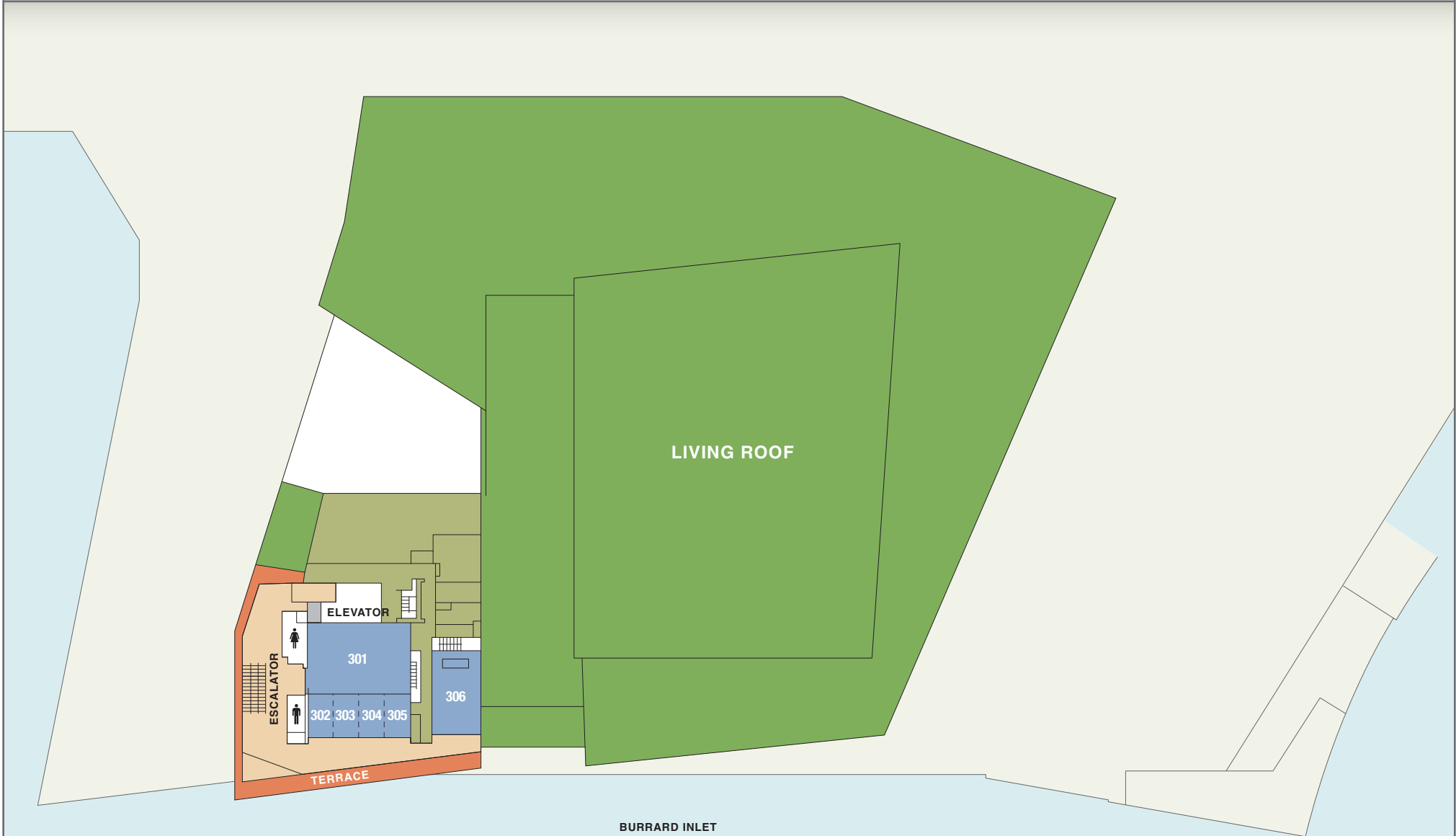

- MEETING ROOMS
- LOBBY / FOYER
- TERRACE
- BACK OF HOUSE

VCEC WEST LEVEL 3

Meeting Rooms	Capacities (Maximum)						Useable Area		Dimensions		Ceiling Height	
	Theatre	Classroom	Dining	Reception	Boardroom	Hollow Square	ft ²	m ²	Feet	Metres	Feet	Metres
301	345	204	230	454	50	70	4,086	380	76'8" x 53'2"	23.41 x 16.22	17'	5.18
302	50	33	30	68	18	14	615	57	32'3" x 19'1"	9.84 x 5.81	17'	5.18
303	50	33	30	68	18	14	611	57	32'3" x 18'9"	9.84 x 5.77	17'	5.18
304	50	33	30	68	18	14	611	57	32'3" x 18'9"	9.84 x 5.77	17'	5.18
305	50	33	30	68	18	14	615	57	32'3" x 19'1"	9.84 x 5.81	17'	5.18
302 & 303	100	66	60	136	28	32	1,226	114	32'3" x 38'	9.84 x 11.58	17'	5.18
303 & 304	100	66	60	136	28	32	1,222	114	32'3" x 37'9"	9.84 x 11.54	17'	5.18
304 & 305	100	66	60	136	28	32	1,226	114	32'3" x 38'	9.84 x 11.58	17'	5.18
302 to 304	150	99	90	204	30	50	1,837	171	32'3" x 56'9"	9.84 x 17.35	17'	5.18
303 to 305	150	99	90	204	30	50	1,837	171	32'3" x 56'9"	9.84 x 17.35	17'	5.18
302 to 305	200	132	120	272	46	60	2,452	228	32'3" x 76'	9.84 x 23.16	17'	5.18
301 to 305	545	336	350	726	46	90	6,538	608	76'8" x 85'5"	23.41 x 26.06	17'	5.18
306	180	114	130	254	46	58	2,284	212	62'5" x 36'5"	19.05 x 11.14	17'	5.18
Total							8,822	820				

Information subject to change.

FLOOR SUMMARY

Meeting Rooms

- 8,822 ft² (820 m²) of meeting space
- Six fully serviced and configurable meeting rooms with spectacular harbour and mountain views
- Outdoor terrace with ocean view
- Sizes range from 600 ft² to 6,500 ft² (55.7 to 603.9 m²)
- Unique, six acre (2.4 hectare) living roof featuring a variety of 400,000 indigenous plants